



AWAIR

Mesh Mount Kit for AwairNet

Installation Guide

Overview

Package Contents – Leader Mesh Mount

Package Contents – Node Mesh Mount

What You'll Need

Preparing for Installation & Onboarding

Assembling Your Mesh Mount

Installing and Placing Your Mesh Mount

Installation Guide Card

Assemble Omni to Mesh Mount

Product Specifications

Package Contents

Leader Mesh Mount

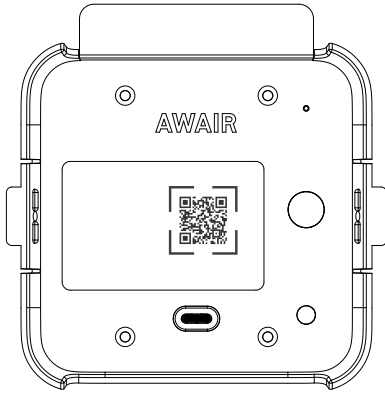

Mesh Mount

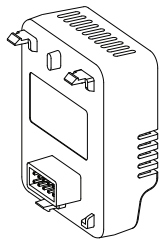

Awair Omni Backpack

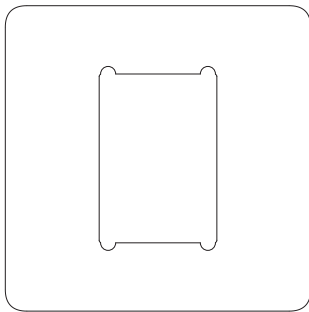

Gang Plate Cover

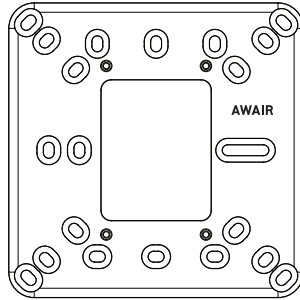

Gang Plate



Drywall Anchors & Screws
(4 pairs)



Electrical Box Screws
(4)



Gang Plate Screws
(4)

Package Contents

Node Mesh Mount

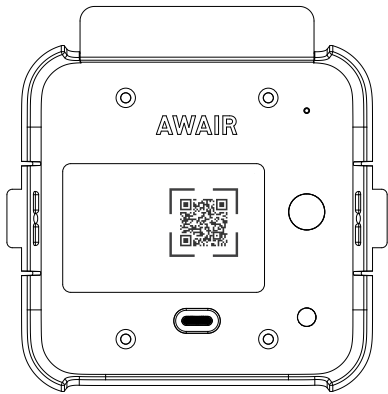

Mesh Mount

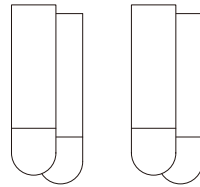

Hanging Strips
(2 pairs)



Security Screws
(2 pairs)

What you'll need

- Awair Omni per mesh device (optional for leader)
- Awair Mesh Mount Kit(s)
- One Awair Omni Backpack
- USB-C Cable (Included with Awair Omni)
- Outlet Power Adapter (Included with Awair Omni)
- 2mm Hex Screwdriver
- 2mm Flathead Screwdriver
- Level

Preparing for Installation & Onboarding

Awair Omni devices can transmit data using a mesh network. Before you onboard your new device(s) or begin the Mesh Mount installation process, set up your Leader Device and then the Node Devices.

Designate a Leader Mesh Mount

1. Select a Mesh Mount

2. Select Your Power Source from the options below.
(USB-C or Power over Ethernet (POE))

Select any Mesh Mount to promote to the leader.

USB-C

1. Plug the USB-C end of your Power Cord into the port on the back of the Mesh Mount and fit the cord into the well that extends from the USB-C port to the bottom edge of the Mesh Mount

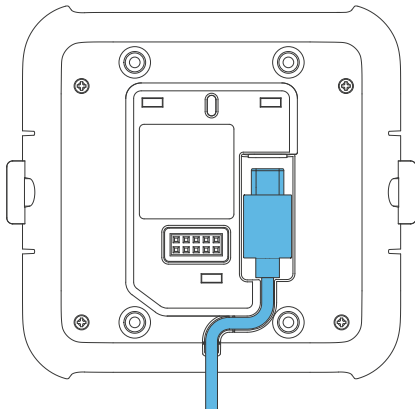

Power over Ethernet (POE)

1. Take the Awair Omni backpack and attach it to the back of the Mesh Mount.

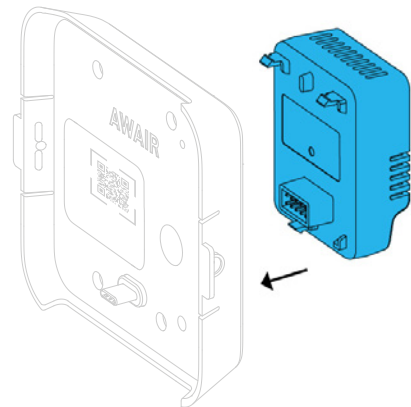

2. Take the Awair Omni backpack and attach it to the back of the Mesh Mount.

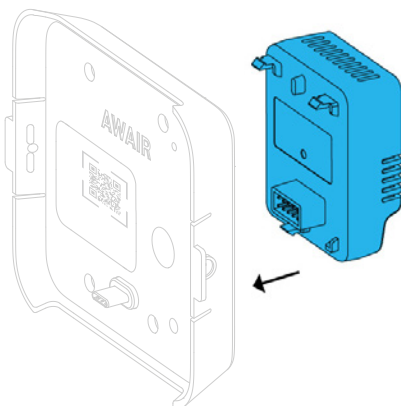

Connect to ethernet

Connect the device to your network. Plug an Ethernet cable into the Ethernet port on the Awair Omni backpack. You should hear a click sound and see a green light on the cable port.

The Mesh Mount will use DHCP to get an IP from the network.

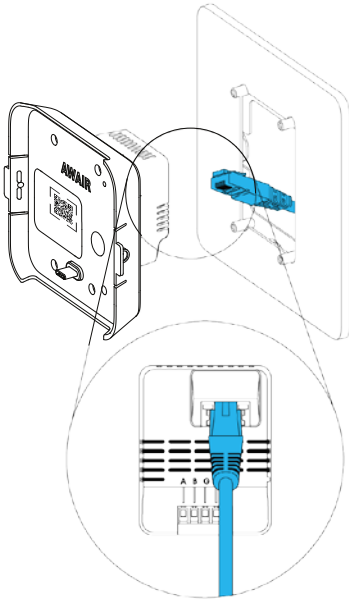

Check for power connection

After the power source is connected, check for a blue LED light in the upper right corner of Mesh Mount.

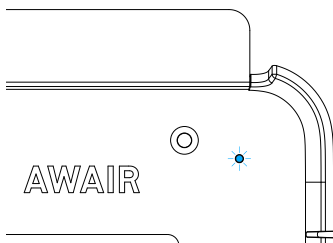

Promote Mesh Mount to Leader

1. Locate the large button on the right of the Mesh Mount. Press and hold the button for 2 seconds and then release.

You should see the blue LED light change to blinking purple.

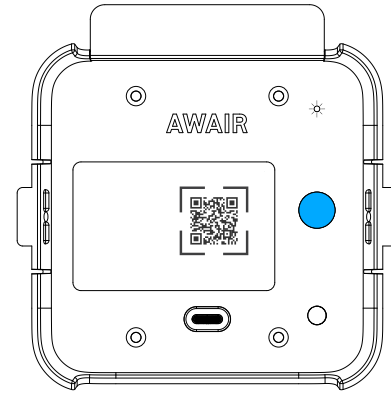

2. Within 60 seconds, the Mesh Mount will beep and the LED light will begin blinking white to show it is in onboarding mode.

The AwairNet mesh network has been created and network credentials have been generated.

3. After 20 seconds of inactivity, the Leader device will move into normal operation mode as shown by a blinking green light and three beeps.

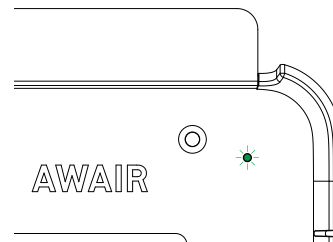

To return to onboarding mode, press and release the large button quickly (within half a second). The LED light will begin blinking white to show it is again in onboarding mode.

Onboard Node Mesh Mounts to the Network

1. Select a Mesh Mount

2. Power Your Node Mesh Mount

Plug the USB-C end of your Power Cord into the port on the back of the Mesh Mount and fit the cord into the well that extends from the USB-C port to the bottom edge of the Mesh Mount.

Attach the Outlet Power Adapter to the end of the Power Cord and plug it into the nearest electrical outlet.

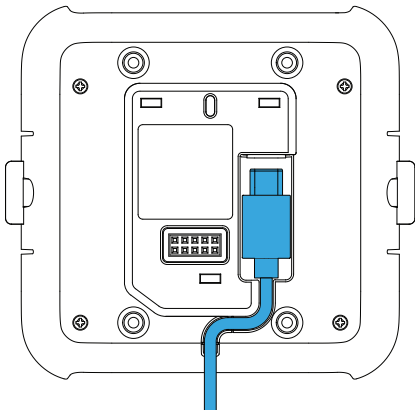

Check for Power Connection

After the power source is connected, check for a blue LED light in the upper right corner of Mesh Mount.

The blue light also indicates that the Mesh Mount is ready to join the network.

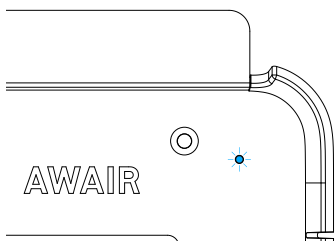

Prepare to onboard

Ensure that your Leader Mesh Mount is on hand and its LED light is blinking white to show that it is in onboarding mode.

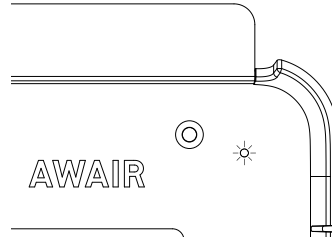

Bring the QR code on the face of the Node Mesh Mount to within an inch of the QR code on of the face of the Leader Mesh Mount.

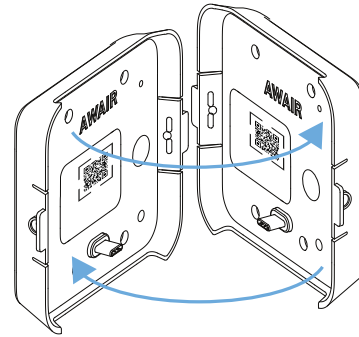

Please Note: Both units must be powered at this time

You should hear a beep from the Leader Mesh Mount and its LED light will briefly show blue. The Node Mesh Mount's LED light will briefly blink red, then yellow, and then green.

It may take up to 60 seconds for the light to turn green.

When the LED light is steady green on the Node Mesh Mount, your network credentials have been successfully passed and the Mesh Mount has been onboarded to the mesh network.

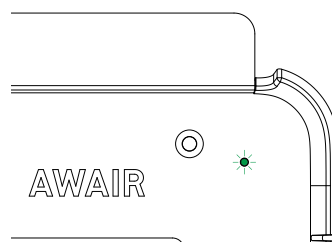

Factory Reset Your Mesh Mount(s)

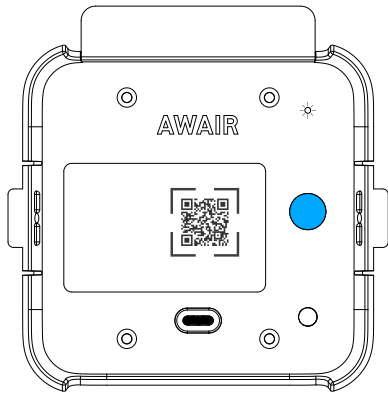

In some cases, you may need to reset your Mount to factory settings – if you accidentally designated two leaders, for example.

Locate the large button on the right of the mount. Press and hold the button for at least 6 seconds. The LED will blink white rapidly.

When you release the button, the device will factory reset, power off, and restart.

Assembling Your Mesh Mount

For in-wall installations, follow the instructions provided in the [In-Wall Mount Kit Installation Guide](#).

1. Gather your Leader Mesh Mount and onboarded Node Mesh Mount(s).

Even when powered off Mesh Mounts will remember their credentials.

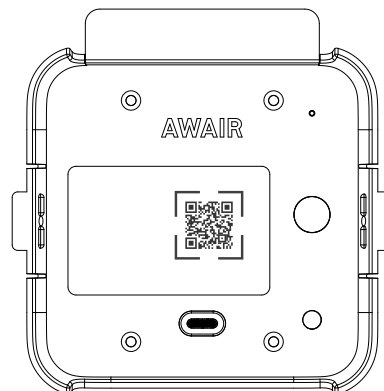

2. Fold your two pairs of Command Strip in half so that the Velcro sides lock together and the sticker sides face outwards. Peel off the tape on one side of each Command Strip Pair.

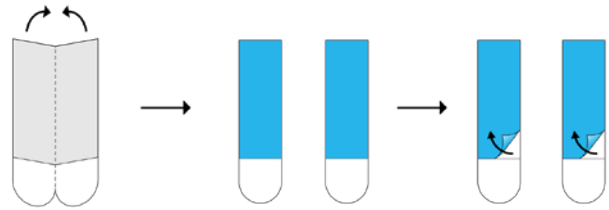

3. Attach the sticky side of your Command Strip Pairs to the back of the Mesh Mount as pictured. The tabs should extend over the bottom edge of the Mesh Mount to ensure clean and easy removal/repositioning.

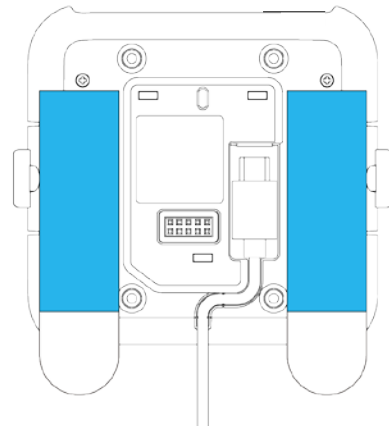

Installing & Powering Your Mesh Mount(s)

Install the Leader Mesh Mount

1. The Leader Mesh Mount establishes the mesh network. Install this device first.

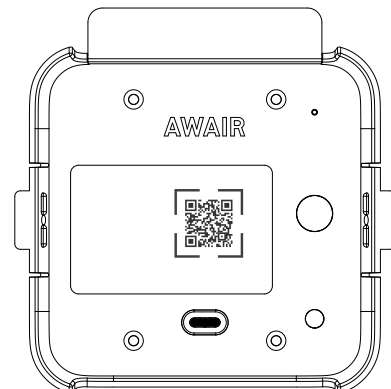

2. Before hanging the Mesh Mount, measure to ensure that your desired mounting location is in proximity to an electrical outlet. Devices should be mounted 3 to 6 feet from the ground (90 centimeters to 1.8 meters high) and at least 16 feet (5 meters) away from operable windows, air filters, and fresh air diffusers.*

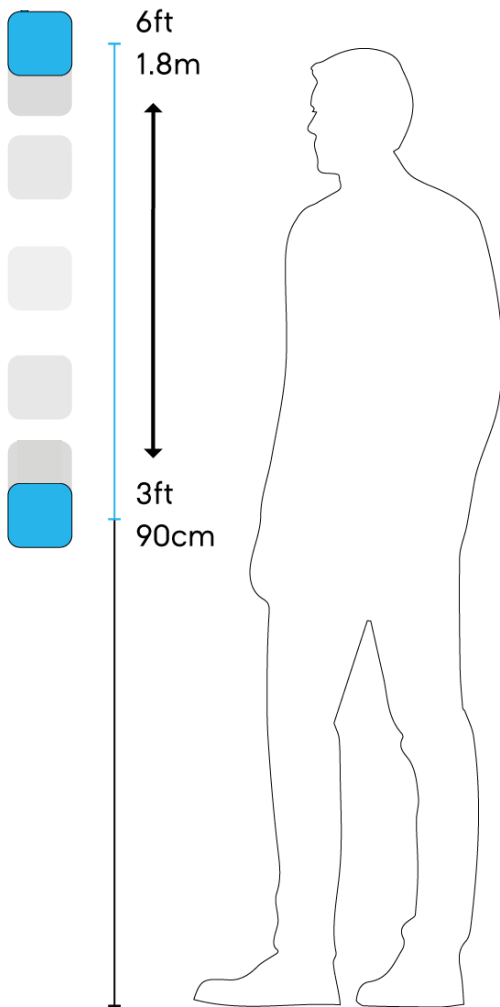

*In areas where this is impossible, center your device between windows and place your monitor closer to air returns than air diffusers.

3. Once you've chosen a mounting location, peel the stickers off of the remaining two Command Strips attached to the back of your Mesh Mount.

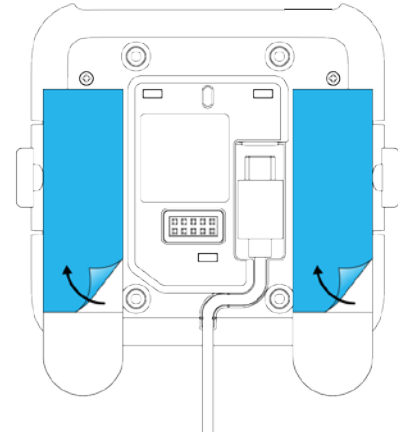

4. Use your level to help straighten your Mesh Mount and press firmly into the wall to secure the Command Strips in place.

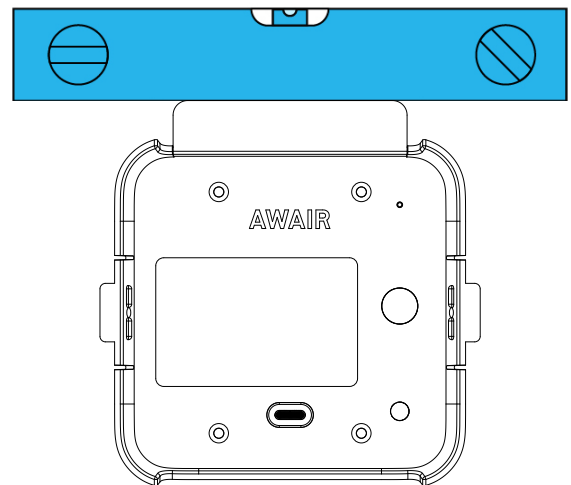

5. Power your Mesh Mount by plugging an Ethernet cable from your PoE Switch into the Ethernet port.

6. The LED on the Leader Mesh Mount should blink green to indicate that the device has power and that the network has been established.

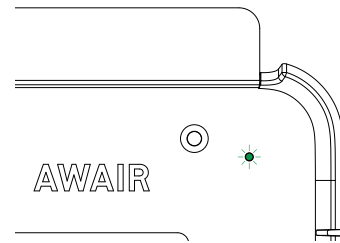

Install the Node Mesh Mounts

1. Following steps 2 to 4 above, install the Node Mesh Mount(s).

Install the Node Mesh Mounts from closest to the Leader Mesh Mount to furthest away. This will help the NodeEnd devices join and extend the network successfully.

2. Attach the Outlet Power Adapter to the end of the USB-C Power Cord and plug it into the nearest electrical outlet.

3. The LED on the Node Mesh End Mount should show steady green to indicate that it is in range and has joined the mesh network.

This can take as long as 5 minutes after installation and power has been applied.

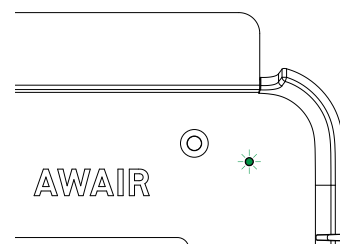

Installation Guide Card

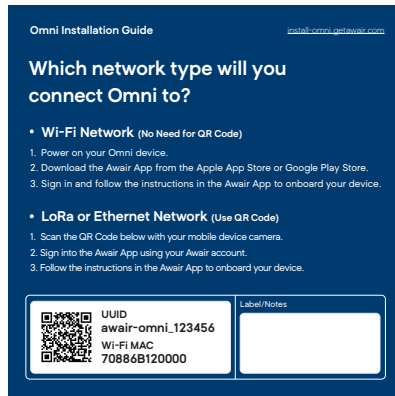

The blue guide card consists of device-specific information, such as the UUID, the MAC address and the QR Code, which will be used with the Awair Business app to onboard your device. Please record the device-specific information.

Please have this card ready to onboard the Omni to your dashboard as in the Getting Started with Omni - Setting Up Your Devices, Dashboard & Data document

Assemble Omni to Mesh Mount

1. Click your Awair Omni into the Mesh Mount and press the power button on the right side of the device to turn it on. The LED light should blink to indicate that the device has power.

The word **MESH** will appear on the screen as it powers up.

It can take up to 5 minutes for sensor data to be available on the dashboard and app

2. If you'd like to lock your Awair Omni device into the Mesh Mount, use your 2mm Hex Screwdriver to screw the Security Screws into the holes on the right and left side of the Mesh Mount, as pictured.

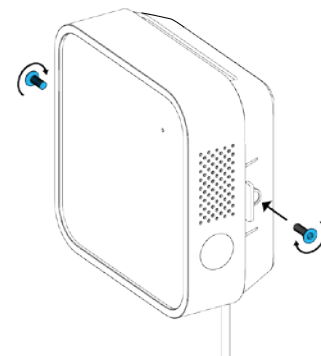
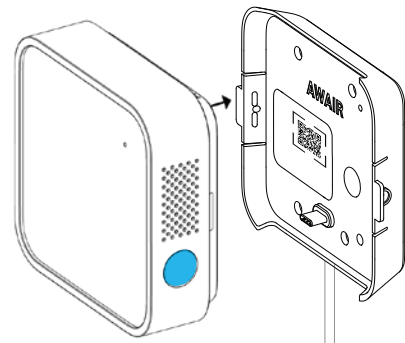

LED Behaviors

For a Node (non-leader)

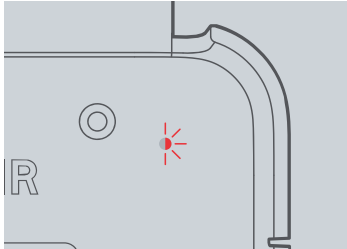

Blinking Red
Detecting a Mesh

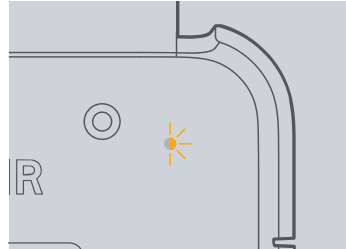

Blinking Amber
Creating Sensor Data
Pathway

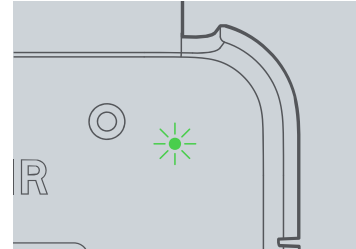

Solid Green
Connected

For a Leader

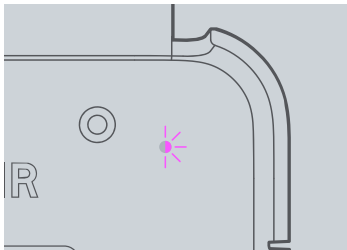

Blinking Purple
Creating Sensor Data
Pathway

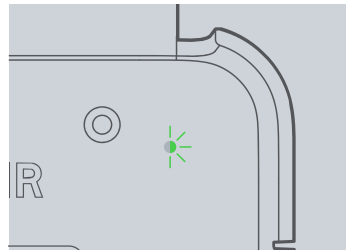

Blinking Green
Connected

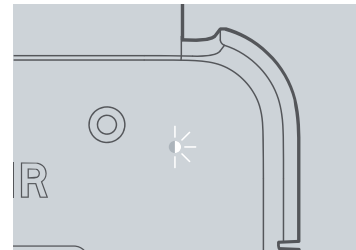

Blinking White
Onboarding Mode

For every device, regardless of use

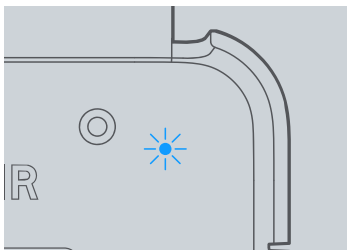

Solid Blue
Factory Mode

If you have any questions, please feel free to contact:
sasha@getawair.com



AWAIR